

SITE LEGEND

- EXISTING 5 FT. CONTOURS - - - - - 7565
- EXISTING 1 FT. CONTOURS - - - - - 92'-0"
- NEW CONTOURS - - - - -
- PROPERTY LINE - - - - -
- EASEMENT, SETBACK OR ENVELOPE - - - - -
- PROPOSED NEW PROPERTY LOT LINE - - - - -
- EXISTING PROPERTY LOT LINE - - - - -
- EXISTING TREE (TO REMAIN) - - - - -
- EXISTING TREE DRIPLINE - - - - -
- 14'-0" WIDE PERVIOUS PAVING DRIVEWAY (W/ "TWO-TRACK" VEGETATION STRIP) - - - - -
- PERVIOUS PAVING COURTYARD (PARKING) - - - - -
- RE-VEGETATED NATIVE GRASS MEADOW - - - - -

GENERAL SITE NOTES

1. GRADING NOTES & SPOT ELEVATIONS, SEE CIVIL DRAWINGS
2. UTILITY AND LOCATION INFORMATION, SEE CIVIL DRAWINGS
3. AREA OF DISTURBANCE TO BE MINIMIZED BY CONTRACTOR
4. SPECIFIC TREE REMOVAL SPECIFICATIONS, SEE LANDSCAPE
5. RETAINING WALLS, TERRACES, AND FENCES, SEE LANDSCAPE FOR LOCATION & APPEARANCE

- PROTECTED GRASSLANDS, ZONE A - - - - -
- PROTECTED GRASSLANDS, ZONE B - - - - -
- 100' BUFFER FROM LEPTOSIPHON - - - - -

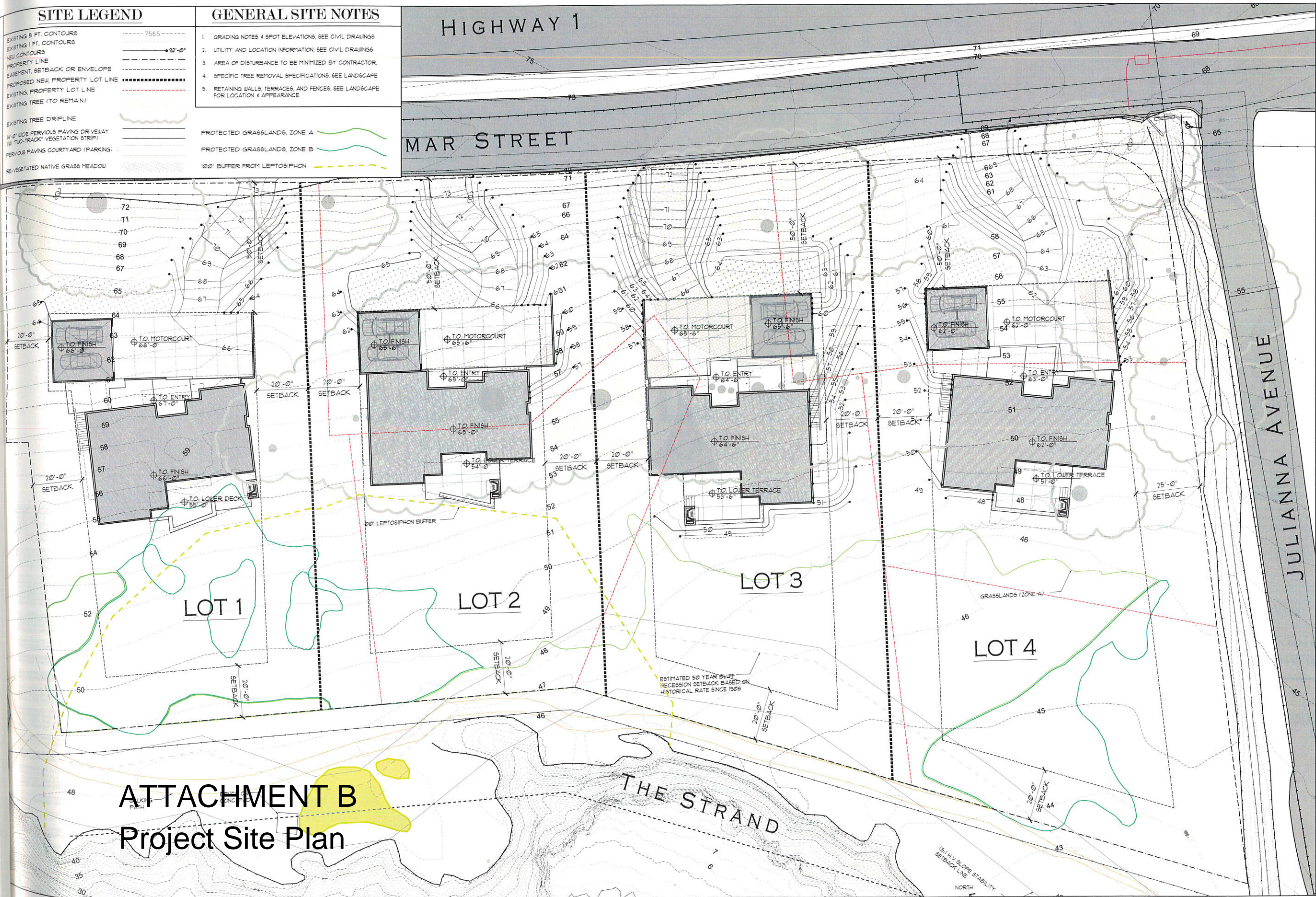

MOSS BEACH - OVERALL
 VALLEMAR ST. & JULIANA AVE.

COASTSIDE DESIGN
 REVIEW APPLICATION
 DRAWING:
 SITE PLAN
 PROJECT NUMBER: 1507
 DATE: OCTOBER 12, 2017
 DESIGN REVIEW SET
 SHEET NO.

A1.0

ATTACHMENT B
Project Site Plan

SITE PLAN
 SCALE: 1/16"=1'-0"